

ANTLER RIDGE

POLK CITY, IA

Lots 9-16 back to trees. Grade allows daylight windows.

PLAT 2

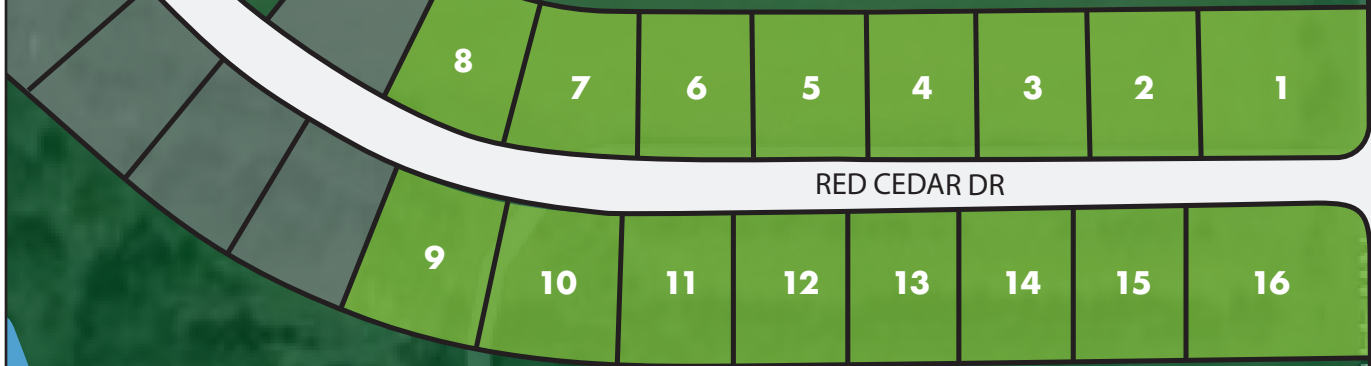

Lot Price Availability Grade

1	\$119,000	Available	Standard	9	\$139,000	Available	Daylight
2	\$119,000	Available	Standard	10	\$139,000	Available	Daylight
3	\$119,000	Available	Standard	11	\$139,000	Available	Daylight
4	\$119,000	Available	Standard	12	\$139,000	Available	Daylight
5	\$119,000	Available	Standard	13	\$139,000	Available	Daylight
6	\$119,000	Available	Standard	14	\$139,000	Available	Daylight
7	\$119,000	Available	Standard	15	\$139,000	Available	Daylight
8	\$119,000	Available	Standard	16	\$139,000	Available	Daylight

Pricing and availability believed to be accurate and are subject to change without notice. Seller does not warrant soil conditions. It is recommended Buyer(s) perform such tests.

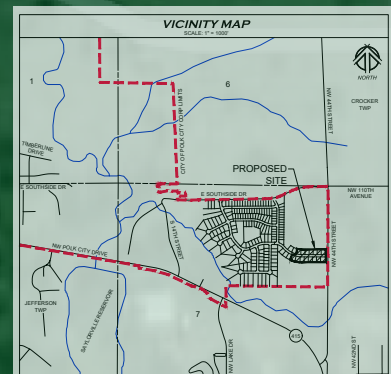

NW 44TH STREET

For more information

Julie Larson, Realtor®

Julie.larson@cbdsm.com

515-360-1297

COLDWELL BANKER | MID-AMERICA



J LARSON HOMES

FINE HOMES & DEVELOPMENTS

Antler Ridge, LLC

www.larsondev.com